

FlowTimer+ Sound Set

FlowTimer+ wireless pre-alarm using
of a pre-wired Honeywell wireless gong set

Operating Manual



Publisher usetech GmbH
Tanzplatz 10
D- 55130 Mainz
Phone: +49 6131 - 921325
Website: www.use-tech.com

Document number FlowTimer+ Sound_Manual_EN_V4
Original Operating Manual

Date of issuance 26.06.2020

Printing date 26.06.2020

Copyright usetech GmbH

This documentation including all its parts is protected by copyright. Any use or modification outside the narrow limits of copyright law without the consent of the company usetech GmbH is prohibited and punishable by law.

This applies in particular to duplications, translations, microfilming and storage in electronic systems as well as processing in these.

Table of contents

Table of contents	1
1 General information	3
1.1 Explanation of symbols	3
2 Technical data	5
3 Intended Use	6
3.1 Non-approved use.....	7
4 System description FlowTimer+ Sound Set	8
4.1 Content of the FlowTimer+ Sound Set.....	8
4.2 Front view Honeywell wireless gong	9
4.3 Plan view Honeywell wireless gong	10
4.4 Rear view Honeywell wireless gong.....	11
4.5 Overview Honeywell Wireless Converter	12
5 Installation	13
5.1 Mounting of converter and wireless gong	13
5.2 Electrical connection	13
5.3 Insert batteries.....	14
6 Operation and Function	15
6.1 Reset wireless gong (factory reset).....	15
6.2 Coupling converter and wireless gong	15
6.3 Test wireless connection	16
6.4 Change melody	16
6.5 Change ring color	17
6.6 Changing the optical signalling mode	17
6.7 Muting.....	17
7 Troubleshooting, Maintenance	18
7.1 Maintenance	18

8	Packaging, Transport, Storage	19
9	Disposal	20

1 General information

The operating instructions describe the entire life cycle of the system. Keep this manual in such a way that it is easily accessible to any user and available to any new owner of the system.

NOTE **The operating instructions contain important information on safety!**

Non-observance of these instructions can lead to dangerous situations.

- The operating instructions must be read and understood.

1.1 Explanation of symbols

DANGER

Warns of imminent danger!

Failure to do so will result in death or serious injury.

WARNING

Warns of a potentially dangerous situation!

- Failure to do so could result in serious injury or death.

CAUTION

Warns of a possible hazard!

- Failure to do so may result in moderate or minor injury.

NOTE **Warns of material damage!**

Failure to do so may result in damage to the system or equipment.



indicates important additional information, tips and recommendations that are important for your safety and the proper functioning of the system.



refers to information in this operating manual or other documentation.

➤ **Action steps**

The defined sequence of steps makes it easier for you to use the system correctly and safely.

✓ **Result**

Here you will find the result of a sequence of steps described.

2 Technical data



For technical data please refer to the original data sheets of the Honeywell DC915SCV wireless set (included in the set).

The EC declaration of conformity as well as the original Honeywell operating instructions are also included in the set.

Download the documents at the address:

<https://livewell.honeywell.com/de/turgongs/dc915scv/>



Remark:

The free unused terminal connections of the terminal block included in the set supplied converter type DCP917S from Honeywell must not be used!

3 Intended Use

Please observe the notes in this operating manual as well as the operating conditions and permissible data in the data sheet so that the system functions perfectly and remains operational for a long time. In case of non-observance of these instructions as well as in case of inadmissible interventions into the system, any liability on our part is void, as is the warranty on the system and accessories!

The FlowTimer+ Sound Set consists of a pre-wired battery-operated transmitter and wireless receiver.

Three minutes before the set maximum flow time of the FlowTimer+ is reached, an acoustic and optical signal is emitted by the wireless receiver at short intervals.

If after this system pre-alarm the water flow is interrupted for approx. 40 seconds, the pre-alarm stops and water can be removed again for the previously set flow duration.

A group- / water sensor- or main alarm is not transmitted via this set!

Any other use or use going beyond this shall be deemed improper use. The usetech GmbH is not liable for damages resulting from this. The risk is borne solely by the user.

3.1 Non-approved use

Unapproved use in the sense of a foreseeable misuse shall be deemed to be improper use:

- The I/O connection cable (17) of the converter (1) is only suitable for connection to the FlowTimer+.
- The free terminals of the radio converter must not be used!
- No telephones, ISDN, other devices or adapters may be connected.

4 System description FlowTimer+ Sound Set

4.1 Content of the FlowTimer+ Sound Set



Fig. 4.1: Content of the FlowTimer+ Sound Set

- 1 Honeywell converter with FlowTimer+ I/O connector
- 2 Honeywell wireless gong
- 3 I/O splinter
- 4 I/O connection cable
- 5 1x button cell for converter
- 6 4x baby cell for wireless gong

Original mounting material from Honeywell for the converter and wireless gong.

4.2 Front view Honeywell wireless gong



Fig. 4.2: Front view Honeywell wireless gong type DC915SCV

- 7 Illuminated ring
- 8 Button Volume +
- 9 Key Volume -
- 10 Key Melody selection
- 11 Teach-in button
- 12 Color and signal selection button

4.3 Plan view Honeywell wireless gong

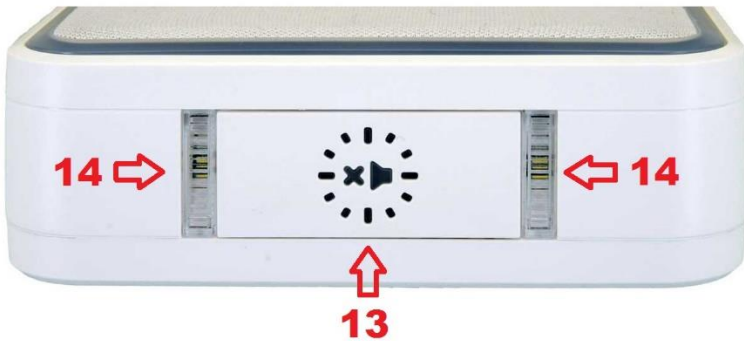

Fig. 4.3: Plan view Honeywell wireless gong type DC915SCV

- 13 Mute button with display
- 14 Optical signal lamps

4.4 Rear view Honeywell wireless gong

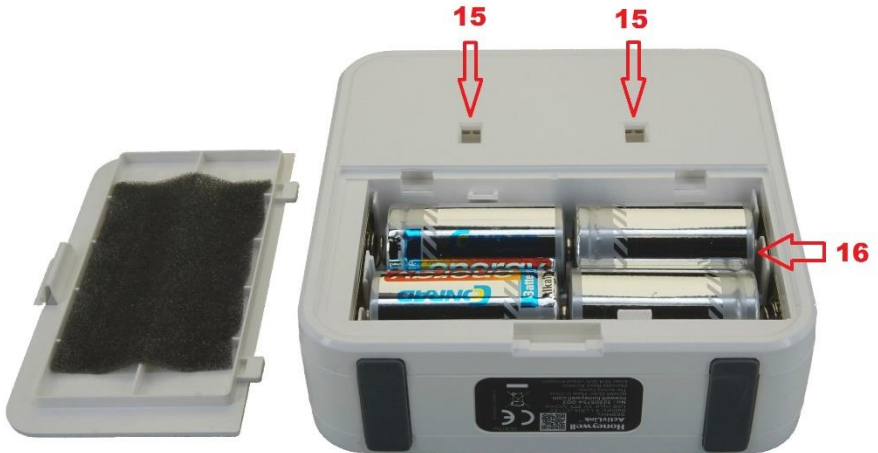

Fig. 4.4: Rear view Honeywell wireless gong type DC915SCV

- 15 Openings for wall brackets
- 16 Battery compartment

4.5 Overview Honeywell Wireless Converter

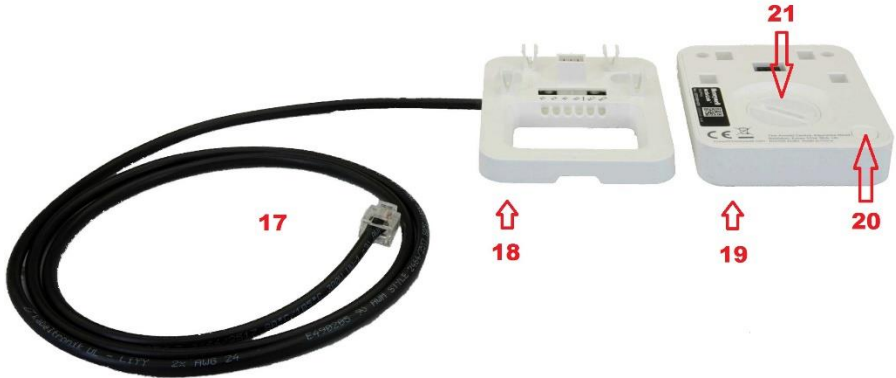

Fig. 4.5: Overview Honeywell Wireless Converter

- 17 FlowTimer+ I/O connection cable
- 18 Converter Mounting and connection plate
- 19 Converter upper part
- 20 Send button
- 21 Battery compartment

5 Installation

5.1 Mounting of converter and wireless gong

If necessary, use the original Honeywell mounting material supplied to attach the converter or wireless gong.

The components must not be mounted over heat sources. Do not mount the parts on a metal surface, as this can impair the wireless connection.

Before final assembly, test whether the wireless range is sufficient.

For this reason, first go through the entire operation (see Chapter 6) and test the wireless connection in accordance with Chapter 6.3.

5.2 Electrical connection

- Plug the connector of the wireless converter I/O cable (17) into the I/O connector of the FlowTimer+ used.



If the I/O plug is plugged into the socket, this must cause a clicking noise. If not, please check again whether the plug is correctly engaged!

When disconnecting connections, please note to press the locking lugs of the I/O connectors!



If also a FlowTimer+ Detect (water sensor) or a FlowTimer+ Hub is connected to the FlowTimer+, please use the I/O splinter (3) and the I/O connection cable (4) included in the set.

For additional information, please refer to the operating instructions of the respective accessories.

5.3 Insert batteries

Remove the wireless converter (19) from the holder (18), open the battery compartment (21) on the rear side with a coin and insert the supplied button cell (5) (observe polarity). Then close the battery compartment again.

Open the battery compartment (16) of the wireless gong (2), insert the four batteries (6) (observe polarity) and close the compartment again.

6 Operation and Function

6.1 Reset wireless gong (factory reset)

- Remove one of the four batteries (6) from the battery compartment (16) of the wireless gong (2).
- Wait 30 seconds
- Press the Teach-in button (11) and keep it pressed!
- Replace the battery at the same time

- ✓ The illuminated ring (7) of the wireless gong indicates the reset!

- Release the Teach-in button (11) and wait until the light ring stops flashing.

6.2 Coupling converter and wireless gong

- Press and hold the Teach-in button (11) on the wireless gong (2) until the light ring (7) indicates the teach-in.
- Remove the wireless converter (19) from the holder (18) and briefly press the transmit button (20) on the back once.

- ✓ The wireless gong acknowledges the learning with a melody and Light signals.

6.3 Test wireless connection

- Remove the wireless converter (19) from the holder (18) and briefly press the transmit button (20) on the back once.
- ✓ The wireless gong acknowledges with a melody and light signals.



If the wireless gong does not react, please change the distance or orientation of the converter and wireless gong and test again.

If necessary, the distance between the devices must be reduced.



If necessary, repeat the steps in chapter 6.1- 6.3.

6.4 Change melody

- Remove the wireless converter (19) from the holder (18) and briefly press the transmit button (20) on the back once.
- ✓ The wireless gong acknowledges with a melody and light signals.
You can now change the melody within 12 seconds.
- Press the Melody selection key (10) repeatedly until the desired melody is played.

6.5 Change ring color

- Remove the wireless converter (19) from the holder (18) and briefly press the transmit button (20) on the back once.

- ✓ The wireless gong acknowledges with a melody and light signals.
You can now change the light ring color within 12 seconds.

- Press the Color and Signal Select button (12) repeatedly until the desired ring color is displayed.

6.6 Changing the optical signalling mode

- Press the Color and Signal Select button (12) repeatedly until the desired signal type is displayed.

-

- ✓ The wireless gong then acknowledges this in the order:
 1. Illuminated ring (7) and additional signal lamps (14) on alarm
 2. Illuminated ring only (7) on alarm
 3. Only signal lamps (14) on alarm
 4. No optical signal on alarm

6.7 Muting

- Press the mute button (13) repeatedly until the desired mute is displayed.

- ✓ The integrated display (13) then acknowledges in sequence:
 1. The melody is muted on alarm (forever)
 2. The melody is muted on alarm (for 3h)
 3. The melody is muted on alarm (for 6h)
 4. The melody is muted on alarm (for 9h)
 5. The melody is muted on alarm (for 12h)
 6. The melody is not muted in case of alarm.

7 Troubleshooting, Maintenance

If the connected FlowTimer+ has shut down without a pre-alarm being triggered, please check the wireless connection (see chapter 6.3).



The wireless gong and the converter are battery operated!

The wireless gong (receiver) announces a pending battery change by two beeps.

After each transmission (see also chapter 6.3), the converter (transmitter) indicates a pending battery change by flashing briefly on the top of the device.

7.1 Maintenance

interval	plot
6 months	Test the wireless connection (see chapter 6.3) and check the battery condition (see above).

8 Packaging, Transport, Storage



Transport damage!

Inadequately protected systems can be damaged during transport.

- Protect the system from moisture and dirt and transport it in shockproof packaging.
- Avoid exceeding or falling below the permissible storage temperature.

The system must be transported or stored in its intended packaging until it is installed.



Incorrect storage can cause damage to the system!

- Store system dry and dust-free!
- Storage temperature: -30°C to +60°C

9 Disposal

Information on the Waste Equipment Ordinance

Act on the placing on the market, take-back and environmentally sound disposal of electrical and electronic equipment (Elektro- und Elektronikgerätegesetz - ElektroG).



Note on the Electrical and Electronic Equipment Act (ElektroG):

Please dispose of old equipment at a municipal collection point as required by law, or hand it over to your local dealer free of charge.

Disposal with household waste is expressly forbidden according to the Old Equipment Ordinance!

You can return devices received from us after use free of charge to us by sending them back sufficiently franked by post to the address given in the imprint.

Old appliances that contain harmful substances are marked with the symbol of a crossed-out dustbin.

Battery Disposal Information

Empty batteries must not be disposed of with household waste! You can hand these in at points of sale in retail or at municipal collection points.